

106 I (1A, 1C)  
106 II (1A, 1C)

08/1991 - 04/1996  
04/1996 - 07/2004

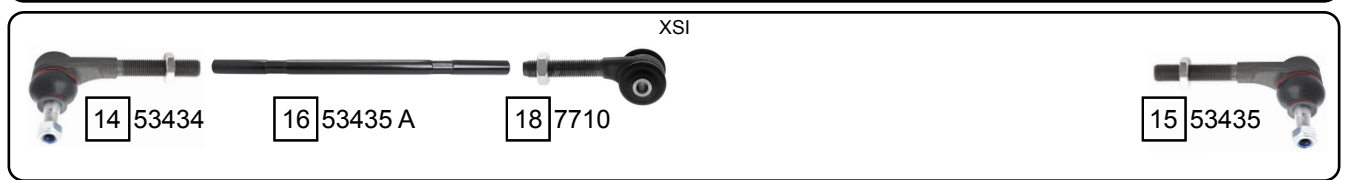
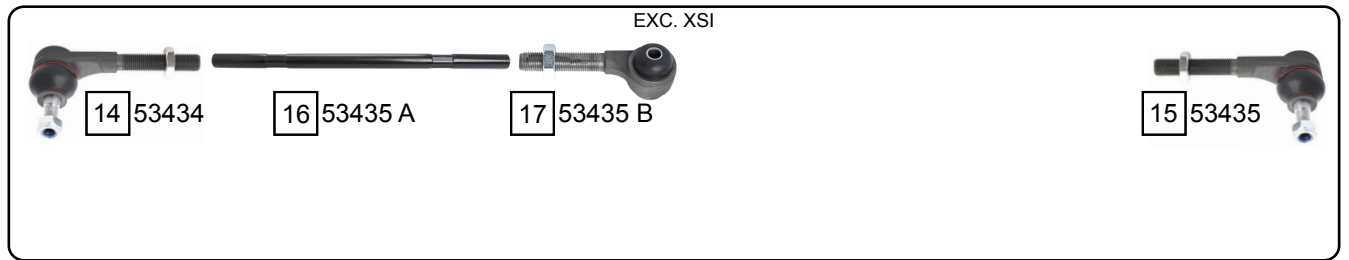
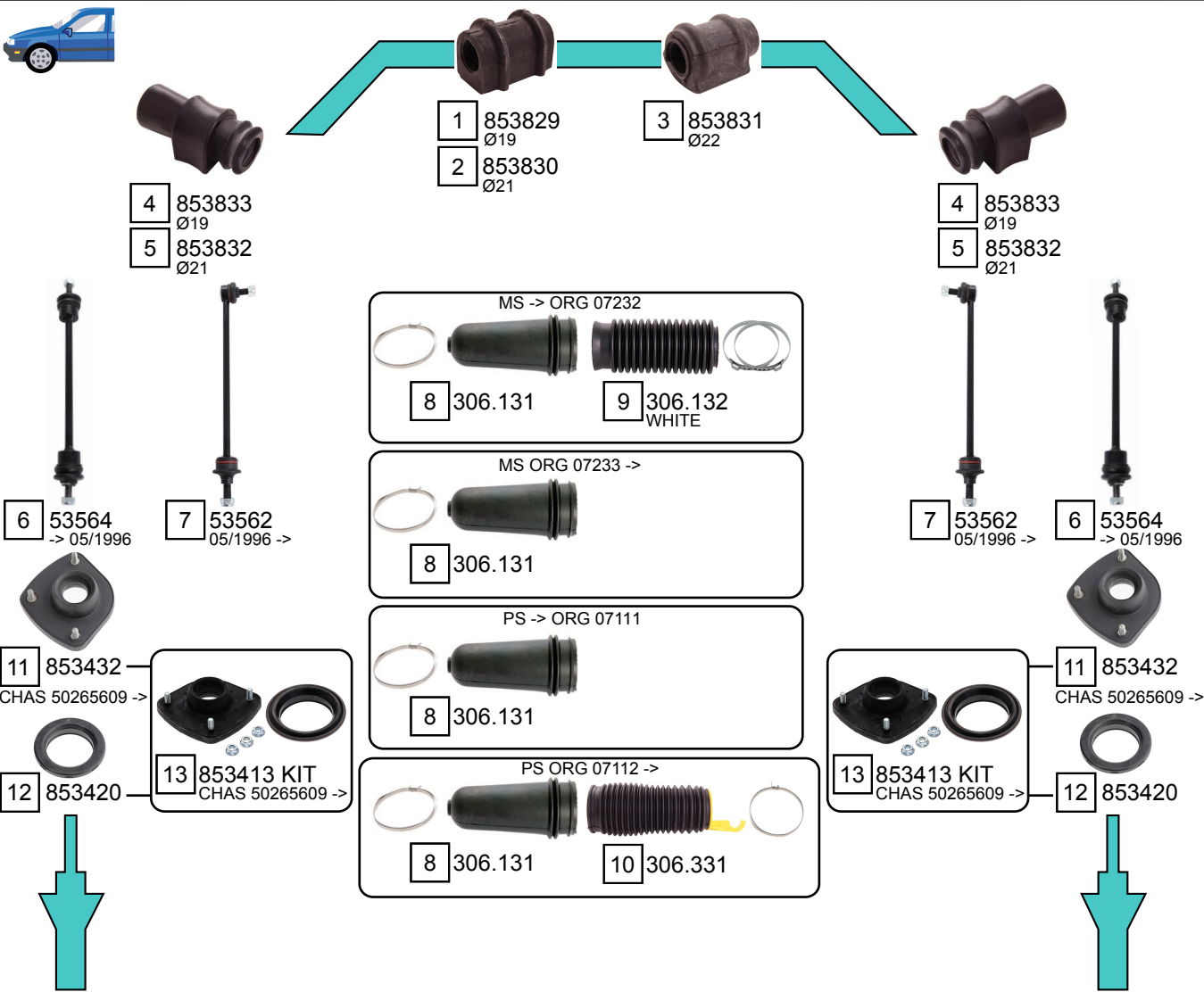

Ref.	Sidem Ref.	Description	OE-number	Measures	Ref.	Sidem Ref.	Description	OE-number	Measures
1	853829	stabilizer mounting	5094 56	di:18.4	10	306.331	steering rack gaiter	4066 50	D:45 d:22 L:120
2	853830	stabilizer mounting	5094 57	di:20.3	11	853432	strut mount	5038 15	di:31.5 do:64 L:36.5
3	853831	stabilizer mounting	5094 71	di:21.6	12	853420	bearing	5035 27	di:65 do:99.5 L:20
4	853833	stabilizer mounting	5094 59	di:19.5	13	853413 KIT	strut mount kit	5031 53	di:31 do:64 L:36
5	853832	stabilizer mounting	5094 60	di:20.5	14	53434	tie rod end	3817 41	c:12.1 th:MM14x1.5R
6	53564	stabilizer link	5087 33	L:300	15	53435	tie rod end	3817 42	c:12.1 th:MM14x1.5R
7	53562	stabilizer link	5087 40	L:323	16	53435 A	connecting piece	3812 A0	L:381
8	306.131	steering rack gaiter	4066 32	D:40 d:12 L:106	17	53435 B	axial joint	3817 32	L:90
9	306.132	steering rack gaiter	4066 34	D:38 d:20 L:134	18	7710	axial joint	3817 33	L:90