

S-CLASS (W116)

08/1972 - 07/1980

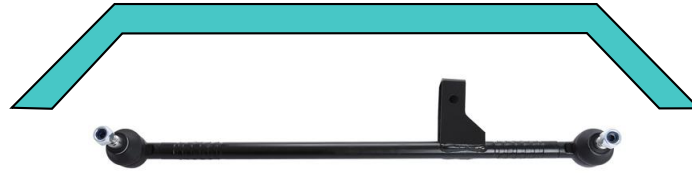

1 49134 C



2 49034



3 49035



2 49034



3 49035



4 49232



5 49282

7 849607



4 49232

6 49283



7 849607



8 49183

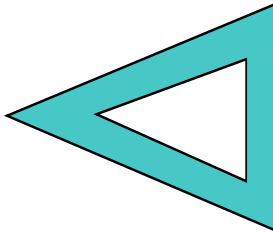

LOWER

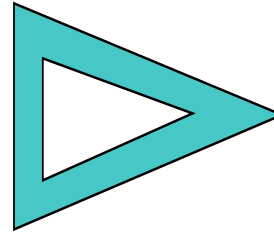

8 49183



9 R10115

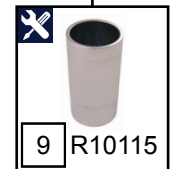

9 R10115



10 49091



10 49091

Ref.	Sidem Ref.	Description	OE-number	Measures	Ref.	Sidem Ref.	Description	OE-number	Measures
1	49134 C	tie rod center	123 460 15 05	L:480	6	49283	TCA right wbj	123 330 47 07	c:13.9
2	49034	tie rod end	000 338 52 10	c:12.7 th:MM14X1.5R	7	849607	silentblock for TCA	116 333 40 14	di:16.4 do:40.5
3	49035	tie rod end	000 338 50 10	c:12.7 th:MM14X1.5L	8	49183	ball joint lower	116 333 09 27	c:18.2 do:45.4
4	49232	tie rod	126 330 05 03	c:12.6	9	R10115	mounting tool ring long ø60	SEE PAGE III	di:52 do:60
5	49282	TCA left wbj	123 330 46 07	c:13.9	10	49091	stabiliser link	115 320 15 89	L:110